

**PUBLIC INFORMATION BULLETIN NO. 4  
DECEMBER 2018**

**DOWSETT HIGHLANDS RELIEF SEWER PROJECTS  
NUUANU AVENUE (SCHOOL ST. TO WYLLIE ST.) &  
PALI HIGHWAY (WYLLIE ST. TO NUUANU PALI DR.) + DOWSETT AVE.  
JOB NOS. W5-17 & W6-17**

**INTRODUCTION**

This bulletin is published to the project website ([www.palisewer.org](http://www.palisewer.org)) monthly to keep the community informed about construction work associated with the Dowsett Highlands Relief Sewer Projects. The contract Notice-To-Proceed was issued to Kiewit Infrastructure West Co. (KIWC) on June 7, 2018. Heavy construction is scheduled to continue through the summer of 2020. Refer to the attached maps and visit the project website for more detailed information about this project. To request hard copies of the monthly information bulletins please call the project hotline at (808) 793-7184.

**UPDATES FOR ONGOING ACTIVITIES**

KIWC performed the following work in December:

***Nuuanu Ave. between School St. & Wyllie St.***

- Underground relocations of water lines at the intersections of Kuakini St. and Bates St.
- Surveying and potholing to confirm locations of existing underground utilities and geotechnical investigation at intersection of School St.

***Pali Hwy. between Wyllie St. & Coelho Way***

- Surveying and potholing to confirm locations of existing underground utilities at various locations.

***Pali Hwy. between Coelho Way & Ahi Pl.***

- Construction of guided bore pipe installation shafts at various locations in the town bound shoulder lane between Coelho Way and Ahi Place.

***Pali Hwy. between Ahi Pl. & Ahipuu St.***

- Convert a pocket of the Honolulu-bound shoulder of Pali Hwy into a project staging area.

**JANUARY FORECAST OF ACTIVITIES**

The activities listed below are scheduled to continue and/or begin in January. The approximate locations and work hours for these activities are shown on the attached maps.

***Nuuanu Ave. between School St. & Wyllie St.***

- Underground relocations of water and gas lines at the intersections of Kuakini St., Pauoa Rd., and Bates St.
- Installation of new sewer pipelines and manholes, including trench excavation and trench restoration, between School St. and Judd St.

***Pali Hwy. between Coelho Way and Jack Lane.***

- Construction of guided bore pipe installation shafts at various locations in the town bound shoulder lane between Coelho Way and Jack Lane.

**TRAFFIC UPDATES FOR JANUARY**

Daytime construction work will require relatively isolated lane closures at several locations on Nuuanu Ave., Kuakini St., and Pali Hwy. Work on Pali Hwy. will involve temporary closure of the right-most inbound travel lane during work hours. Access to driveways will be maintained via right turn motions from the open travel lanes fronting them; however, access to some driveways via left turn motions may not be available due to required traffic control configurations. Please observe the posted construction traffic signage. Thank you for your patience!

**CONTACT INFORMATION**

For more information about this project, please visit the project website: [www.palisewer.org](http://www.palisewer.org) or call the project hotline at (808) 793-7184.

**CONSTRUCTION ACTIVITIES  
SCHEDULED FOR JANUARY 2018**

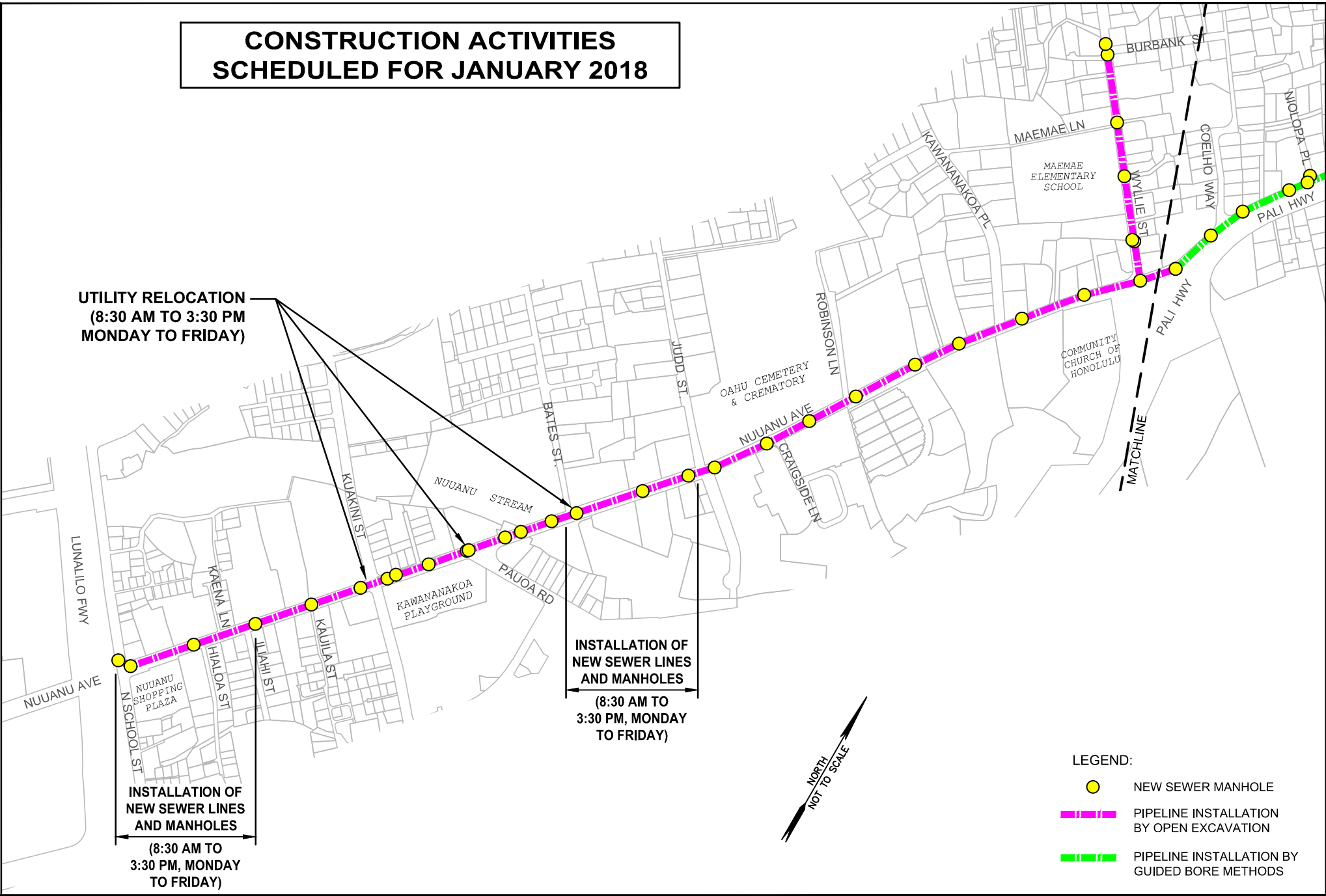

CITY AND COUNTY OF HONOLULU  
DEPARTMENT OF ENVIRONMENTAL SERVICES

**DOWSETT HIGHLANDS RELIEF SEWER PROJECTS  
NUUANU AVENUE (SCHOOL ST. TO WYLLIE ST.) AND  
PALI HIGHWAY (WYLLIE ST. TO NUUANU PALI DR.) + DOWSETT AVE.  
FIGURE 1 OF 2**

# CONSTRUCTION ACTIVITIES SCHEDULED FOR JANUARY 2018

**SHAFT  
CONSTRUCTION**  
(9:00 AM TO  
3:30 PM  
MONDAY TO  
FRIDAY)

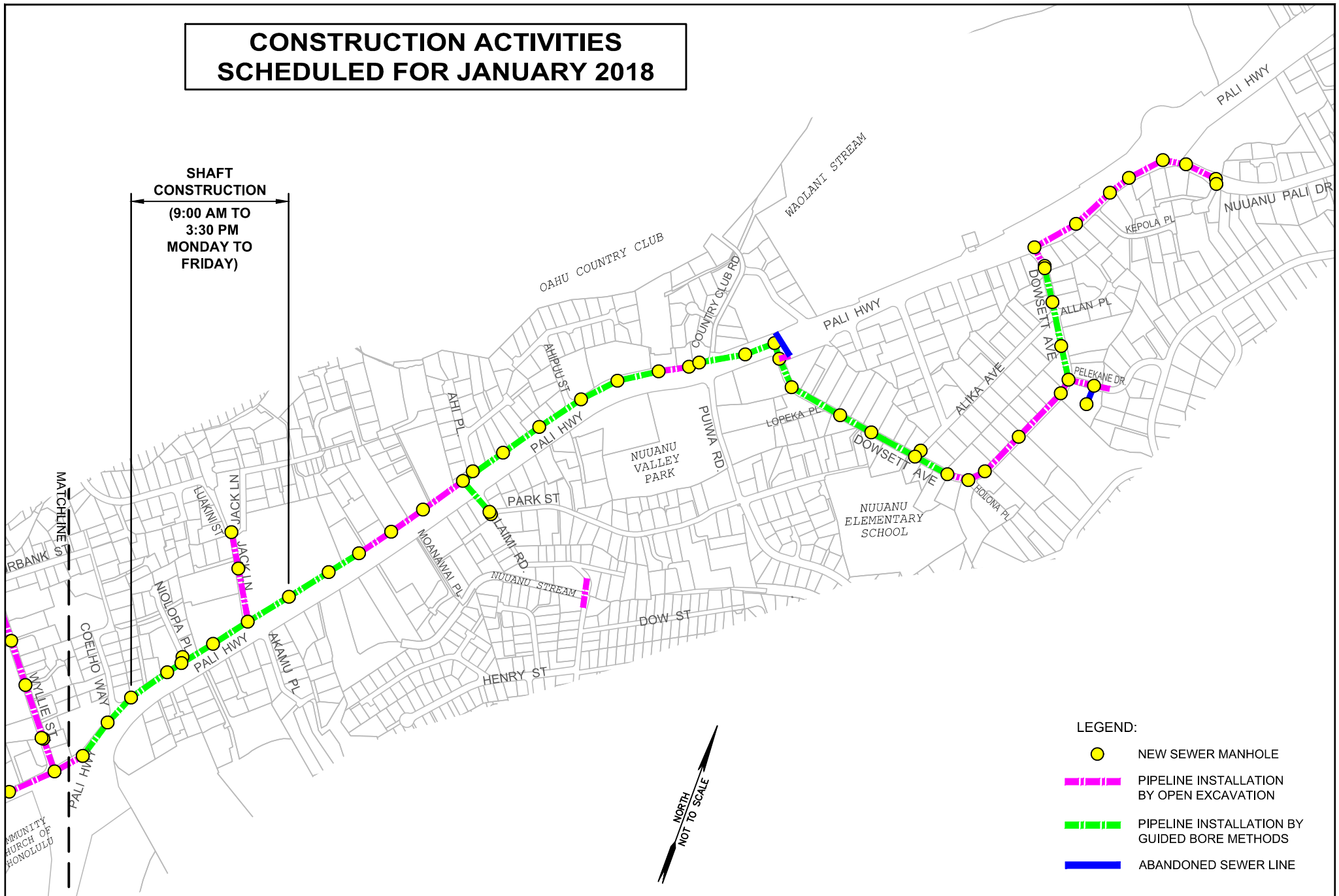

- LEGEND:**
- NEW SEWER MANHOLE
  - - - PIPELINE INSTALLATION BY OPEN EXCAVATION
  - - - PIPELINE INSTALLATION BY GUIDED BORE METHODS
  - - - ABANDONED SEWER LINE



CITY AND COUNTY OF HONOLULU  
DEPARTMENT OF ENVIRONMENTAL SERVICES

**DOWSETT HIGHLANDS RELIEF SEWER PROJECTS  
NUUANU AVENUE (SCHOOL ST. TO WYLLIE ST.) AND  
PALI HIGHWAY (WYLLIE ST. TO NUUANU PALI DR.) + DOWSETT AVE.  
FIGURE 2 OF 2**