

**PUBLIC INFORMATION BULLETIN NO. 3
NOVEMBER 2018
DOWSETT HIGHLANDS RELIEF SEWER PROJECTS
NUUANU AVENUE (SCHOOL ST. TO WYLLIE ST.) &
PALI HIGHWAY (WYLLIE ST. TO NUUANU PALI DR.) + DOWSETT AVE.
JOB NOS. W5-17 & W6-17**

INTRODUCTION

This bulletin is published to the project website (www.palisewer.org) monthly to keep the community informed about construction work associated with the Dowsett Highlands Relief Sewer Projects. The contract Notice-To-Proceed was issued to Kiewit Infrastructure West Co. (KIWC) on June 7, 2018. Heavy construction is scheduled to continue through the summer of 2020. Refer to the attached maps and visit the project website for more detailed information about this project. To request hard copies of the monthly information bulletins please call the project hotline at (808) 793-7184.

UPDATES FOR ONGOING ACTIVITIES

KIWC performed the following work in November:

Nuuanu Ave. between School St. & Wyllie St.

- Surveying and potholing to confirm locations of existing underground utilities at various locations.
- Underground relocations of water lines at the intersection of Bates St. and at various locations between Kuakini St. and Pauoa Rd.

Pali Hwy. between Wyllie St. & Dowsett Ave.

- Surveying and potholing to confirm locations of existing underground utilities at various locations.

DECEMBER FORECAST OF ACTIVITIES

The activities listed below are scheduled to continue and/or begin in December. The approximate locations and work hours for these activities are shown on the attached maps.

Nuuanu Ave. between School St. & Wyllie St.

- Underground relocations of water lines at the intersections of Kuakini St. and Bates St.

Pali Hwy. between Ceolho Way and Ahi Pl.

- Construction of guided bore pipe installation shafts at various locations in the town bound shoulder lane between Coelho Way and Ahi Place.

TRAFFIC UPDATES FOR DECEMBER

Daytime construction work will require relatively isolated lane closures at several locations on Nuuanu Ave., Kuakini St., and Pali Hwy. Access to driveways will be maintained via right turn motions from the travel lanes fronting them; however, access to some driveways via left turn motions may not be available due to required traffic control configurations. Please observe the posted construction traffic signage. Thank you for your patience!

CONTACT INFORMATION



For more information about this project, please visit the project website: www.palisewer.org or call the project hotline at (808) 793-7184.

**CONSTRUCTION ACTIVITIES
SCHEDULED FOR DECEMBER 2018**

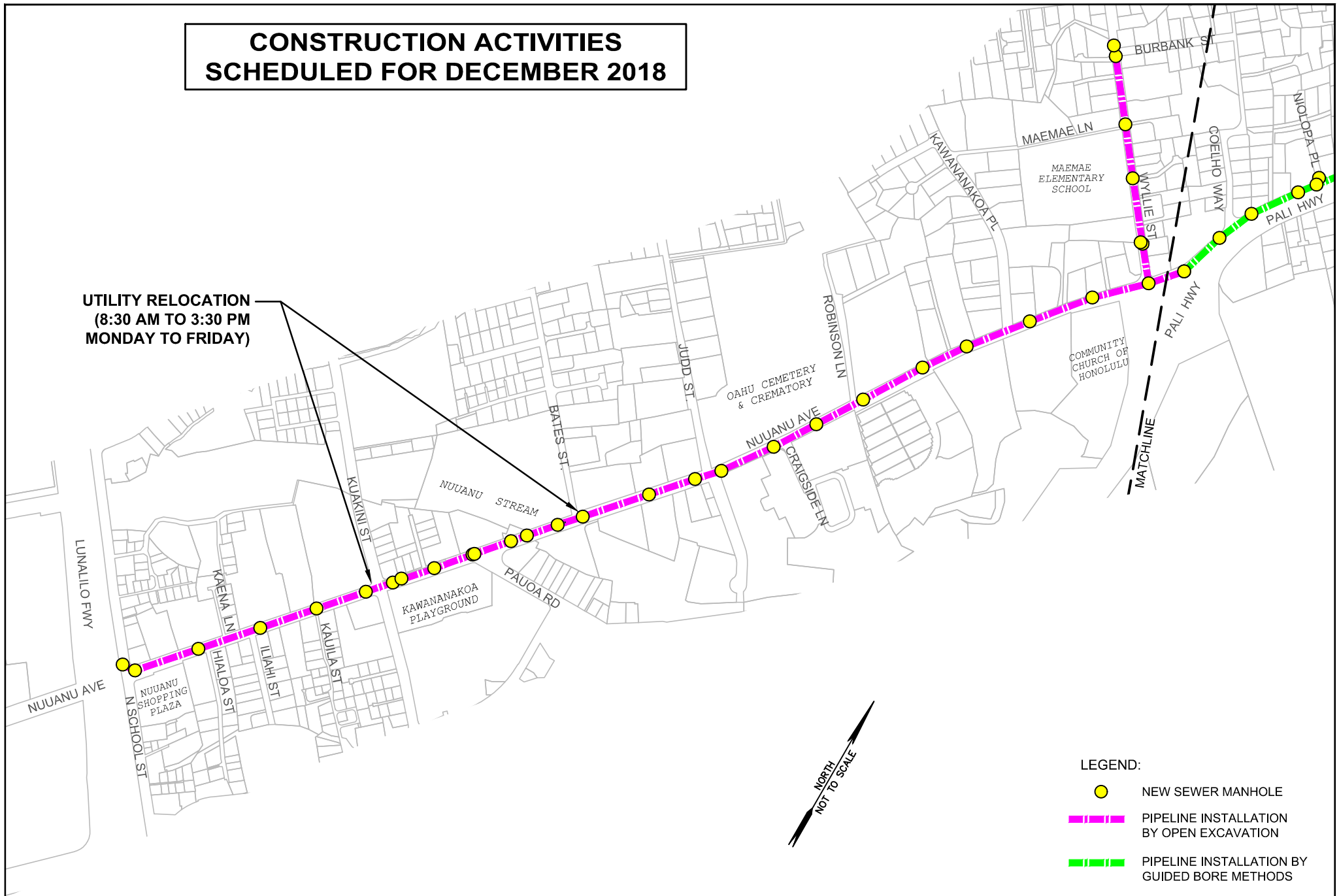
**UTILITY RELOCATION
(8:30 AM TO 3:30 PM
MONDAY TO FRIDAY)**



LEGEND:

-  NEW SEWER MANHOLE
-  PIPELINE INSTALLATION BY OPEN EXCAVATION
-  PIPELINE INSTALLATION BY GUIDED BORE METHODS



CITY AND COUNTY OF HONOLULU
DEPARTMENT OF ENVIRONMENTAL SERVICES

**DOWSETT HIGHLANDS RELIEF SEWER PROJECTS
NUUANU AVENUE (SCHOOL ST. TO WYLLIE ST.) AND
PALI HIGHWAY (WYLLIE ST. TO NUUANU PALI DR.) + DOWSETT AVE.**

CONSTRUCTION ACTIVITIES SCHEDULED FOR DECEMBER 2018

**SHAFT
CONSTRUCTION**
(9:00 AM TO
3:30 PM
MONDAY TO
FRIDAY)

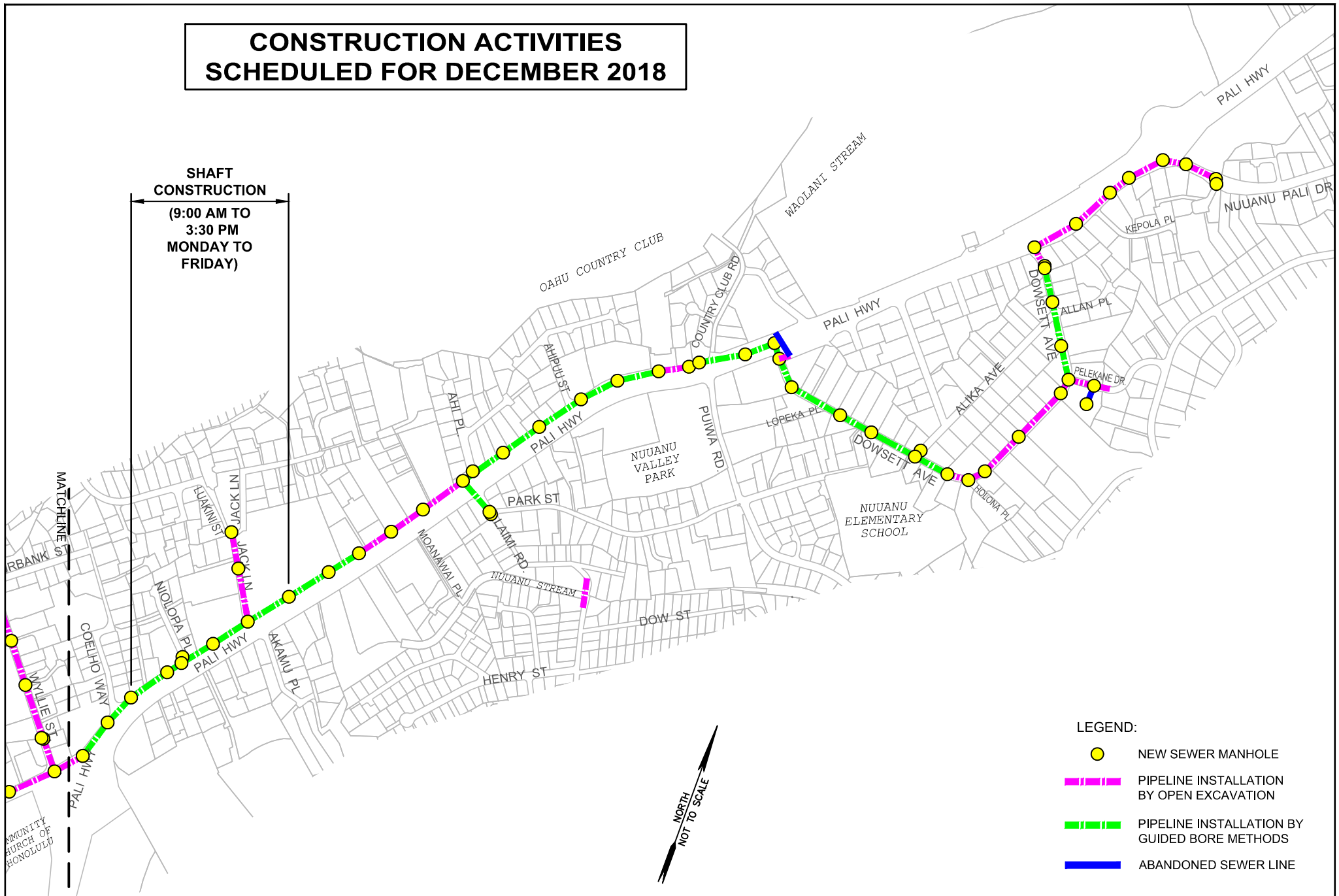

LEGEND:

- NEW SEWER MANHOLE
- PIPELINE INSTALLATION BY OPEN EXCAVATION
- PIPELINE INSTALLATION BY GUIDED BORE METHODS
- ABANDONED SEWER LINE



CITY AND COUNTY OF HONOLULU
DEPARTMENT OF ENVIRONMENTAL SERVICES

**DOWSETT HIGHLANDS RELIEF SEWER PROJECTS
NUUANU AVENUE (SCHOOL ST. TO WYLLIE ST.) AND
PALI HIGHWAY (WYLLIE ST. TO NUUANU PALI DR.) + DOWSETT AVE.
FIGURE 2 OF 2**