

PUBLIC INFORMATION BULLETIN NO. 2 OCTOBER 2018

DOWSETT HIGHLANDS RELIEF SEWER PROJECTS NUUANU AVENUE (SCHOOL ST. TO WYLLIE ST.) & PALI HIGHWAY (WYLLIE ST. TO NUUANU PALI DR.) + DOWSETT AVE. JOB NOS. W5-17 & W6-17

INTRODUCTION

This bulletin is published to the project website (www.palisewer.org) monthly to keep the community informed about construction work associated with the Dowsett Highlands Relief Sewer Projects. The contract Notice-To-Proceed was issued to Kiewit Infrastructure West Co. (KIWC) on June 7, 2018. Heavy construction is scheduled to continue through the summer of 2020. Refer to the attached map and visit the project website for more detailed information about this project. To request hard copies of the monthly information bulletins please call the project hotline at (808) 793-7184.

UPDATES FOR ONGOING ACTIVITIES

KIWC performed the following work in September and October:

Nuuanu Ave. between School St. & Wyllie St.

- Surveying and potholing to confirm locations of existing underground utilities at various locations.
- Utility Relocations

Wyllie St. between Burbank St. & Nuuanu Ave.

- Surveying and potholing to confirm locations of existing underground utilities at various locations.

Pali Hwy. between Dowsett Ave. & Nuuanu Pali Dr.

- Surveying to determine locations of new sewer structures.

Dowsett Ave.

- Surveying and potholing to confirm locations of existing underground utilities at various locations.

NOVEMBER FORECAST OF ACTIVITIES

The activities listed below are scheduled to continue and/or begin in November. The approximate locations and work hours for these activities are shown on the attached map.

Nuuanu Ave. between School St. & Wyllie St.

- Underground relocations of water lines at the intersections of Kuakini St., Bates St., and Judd St.,

and at various locations between Kuakini St. and Pauoa Rd.

Wyllie St. between Burbank St. & Nuuanu Ave.

- Surveying and potholing to confirm locations of existing underground utilities at various locations.

Pali Hwy. between Wyllie St. & Dowsett Ave.

- Setup of project staging areas at various locations in the town bound shoulder lane from Dowsett Ave. to Wyllie St.
- Surveying and potholing to confirm locations of existing underground utilities at various locations.

Pali Hwy. between Dowsett Ave. & Nuuanu Pali Dr.

- Surveying and potholing to confirm locations of existing underground utilities at various locations.

Dowsett Ave.

- Surveying and potholing to confirm locations of existing underground utilities at various locations.

TRAFFIC UPDATES FOR NOVEMBER

Daytime construction work will require relatively isolated lane closures at several locations on Nuuanu Ave., Wyllie St., Dowsett Ave., and Pali Hwy. Access to driveways will be maintained via right turn motions from the travel lanes fronting them; however, access to some driveways via left turn motions may not be available due to required traffic control configurations. Short term detours may be needed for work near Wyllie St. and Dowsett Ave. Please observe the posted construction traffic signage. Thank you for your patience!

CONTACT INFORMATION

For more information about this project, please visit the project website: www.palisewer.org or call the project hotline at (808) 793-7184.

CONSTRUCTION ACTIVITIES SCHEDULED FOR NOVEMBER 2018

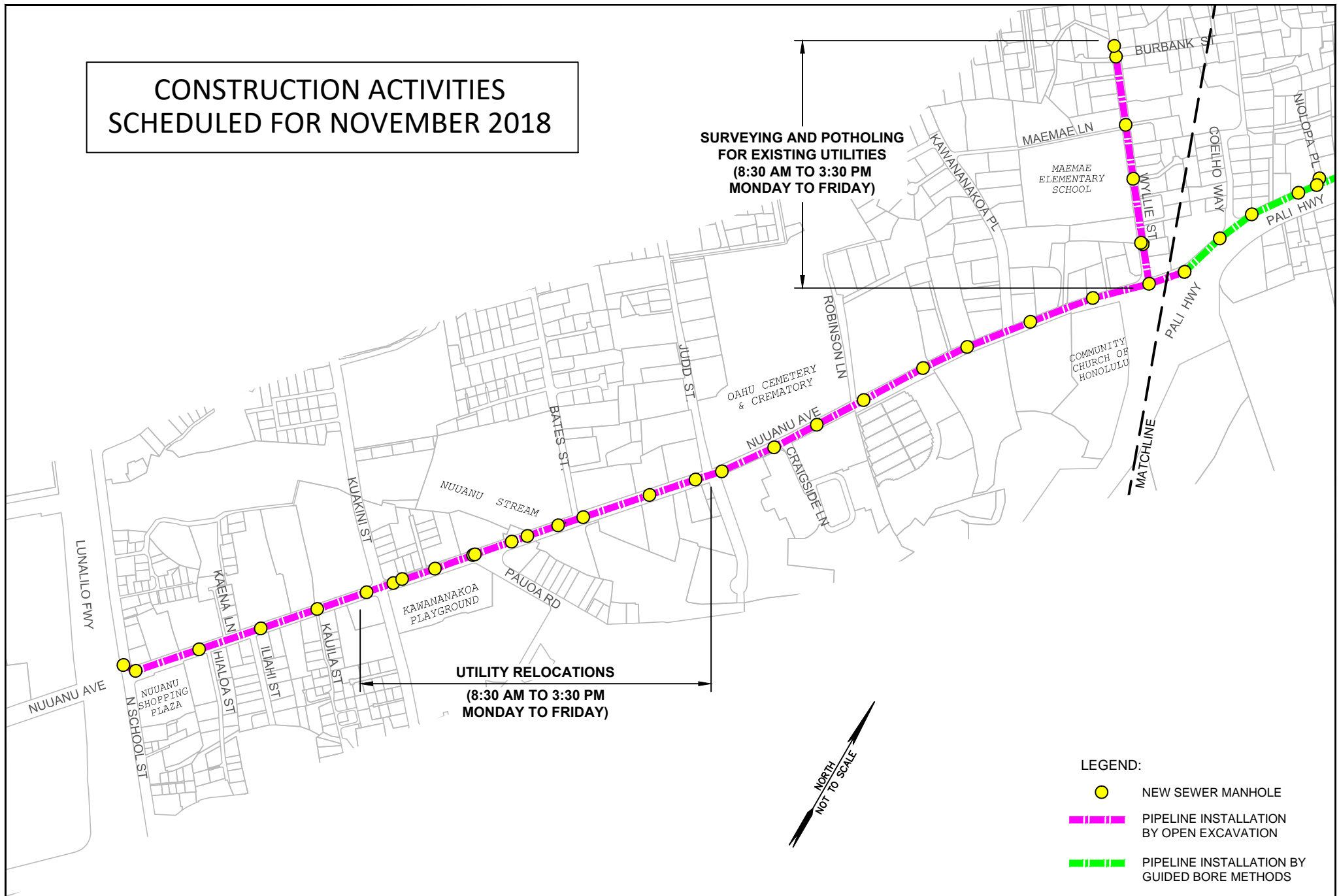

CITY AND COUNTY OF HONOLULU
DEPARTMENT OF ENVIRONMENTAL SERVICES

DOWSETT HIGHLANDS RELIEF SEWER PROJECTS
NUUANU AVENUE (SCHOOL ST. TO WYLLIE ST.) AND
PALI HIGHWAY (WYLLIE ST. TO NUUANU PALI DR.) + DOWSETT AVE.
FIGURE 1 OF 2

CONSTRUCTION ACTIVITIES SCHEDULED FOR NOVEMBER 2018

**SET UP STAGING AREAS FOR STORAGE OF EQUIPMENT AND MATERIALS
AND SURVEYING AND POTHOLING FOR EXISTING UTILITIES**

**(9:00 AM TO 3:30 PM
MONDAY TO SATURDAY)**

SURVEYING AND POTHOLING FOR EXISTING UTILITIES

**(9:00 AM TO 3:30 PM
MONDAY TO SATURDAY)**

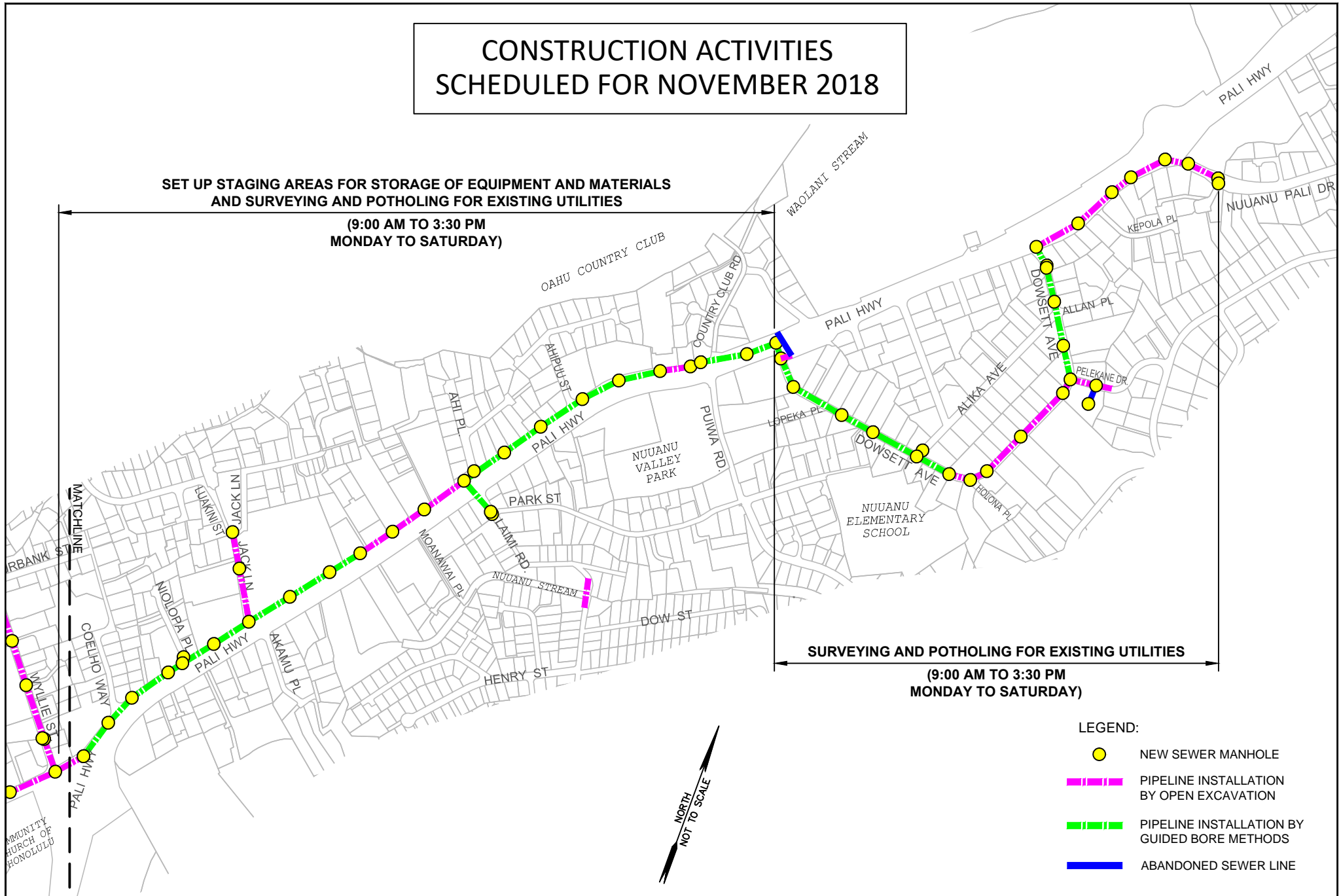

CITY AND COUNTY OF HONOLULU
DEPARTMENT OF ENVIRONMENTAL SERVICES

**DOWSETT HIGHLANDS RELIEF SEWER PROJECTS
NUUANU AVENUE (SCHOOL ST. TO WYLLIE ST.) AND
PALI HIGHWAY (WYLLIE ST. TO NUUANU PALI DR.) + DOWSETT AVE.**

FIGURE 2 OF 2