

PUBLIC INFORMATION BULLETIN NO. 1
SEPTEMBER 2018
DOWSETT HIGHLANDS RELIEF SEWER PROJECTS
NUUANU AVENUE (SCHOOL ST. TO WYLLIE ST.) &
PALI HIGHWAY (WYLLIE ST. TO NUUANU PALI DR.) + DOWSETT AVE.
JOB NOS. W5-17 & W6-17

INTRODUCTION

This bulletin is to keep the community informed about construction work associated with the Dowsett Highlands Relief Sewer Projects. It will be published to www.palisewer.org monthly by the City & County of Honolulu, Department of Environmental Services (ENV), its Construction Management consultant, Yogi Kwong Engineers, LLC (YKE); and its general contractor, Kiewit Infrastructure West Co. (KIWC). Updates and more detailed information will be posted on the project website. To request hard copies of the monthly information bulletins please call the project hotline at (808) 793-7184.

PROJECT DESCRIPTION

This project involves construction of more than 3 miles new gravity sewers along Nuuanu Avenue, Wyllie Street, Pali Highway, Dowsett Avenue, and several side streets (see attached project maps). The extent of work is as follows:

- 11,000 linear feet of new sewer pipelines, ranging from 8 to 24 inches in diameter, installed by open-cut trench construction;
- 6,000 linear feet of new sewer pipelines, ranging from 8 to 18 inches in diameter, installed by guided bore methods (small diameter tunneling);
- 88 new sewer manholes;
- 13 reconstructed sewer laterals;
- Multiple temporary sewer bypass systems;
- 8 water line relocations;
- 2 gas line relocations;
- 1 underground telephone line relocation; and
- Various other site work and restorations.

A combination of Guided Bore Method construction and open-cut trench methods will be used to construct the sewer systems along Pali Highway and Dowsett Avenue. Guided Bore Method construction only requires excavations at manhole locations.

Conditions along Nuuanu Avenue and Wyllie Street require open-cut trench methods for all underground construction in those areas.

CONTRACT DATES

The contract Notice-To-Proceed was issued to KIWC July 9, 2018, enabling the contractors to begin the various tasks required before starting construction.

The substantial completion deadline is June 7, 2020. All new sewer pipelines need to be installed and able to transport wastewater by the completion date. Various construction closeout activities (e.g. pavement and landscaping restoration, punch-list work, etc.) are not contractually required to be completed by June 2020 and may continue for several months after substantial completion.

SCHEDULE & WORK HOURS

Preliminary work such as surveying and potholing to confirm locations of existing underground utilities, began in late August. The level of activity will increase during September and transition into significant construction activities by October 2018. Construction will continue through the summer of 2020.

More specific schedule updates of planned work will be provided in subsequent information bulletins and posted on the project website.

An aggressive schedule is required to substantially complete the project by June 2020. Construction crews will need to work at many concurrent locations throughout the project. Crews may need to work some weekends and holidays, and in some location crews may need to work night shifts.

CONTACT INFORMATION

For more information about this project, please visit the project website: www.palisewer.org or call the project hotline at (808) (808) 793-7184.

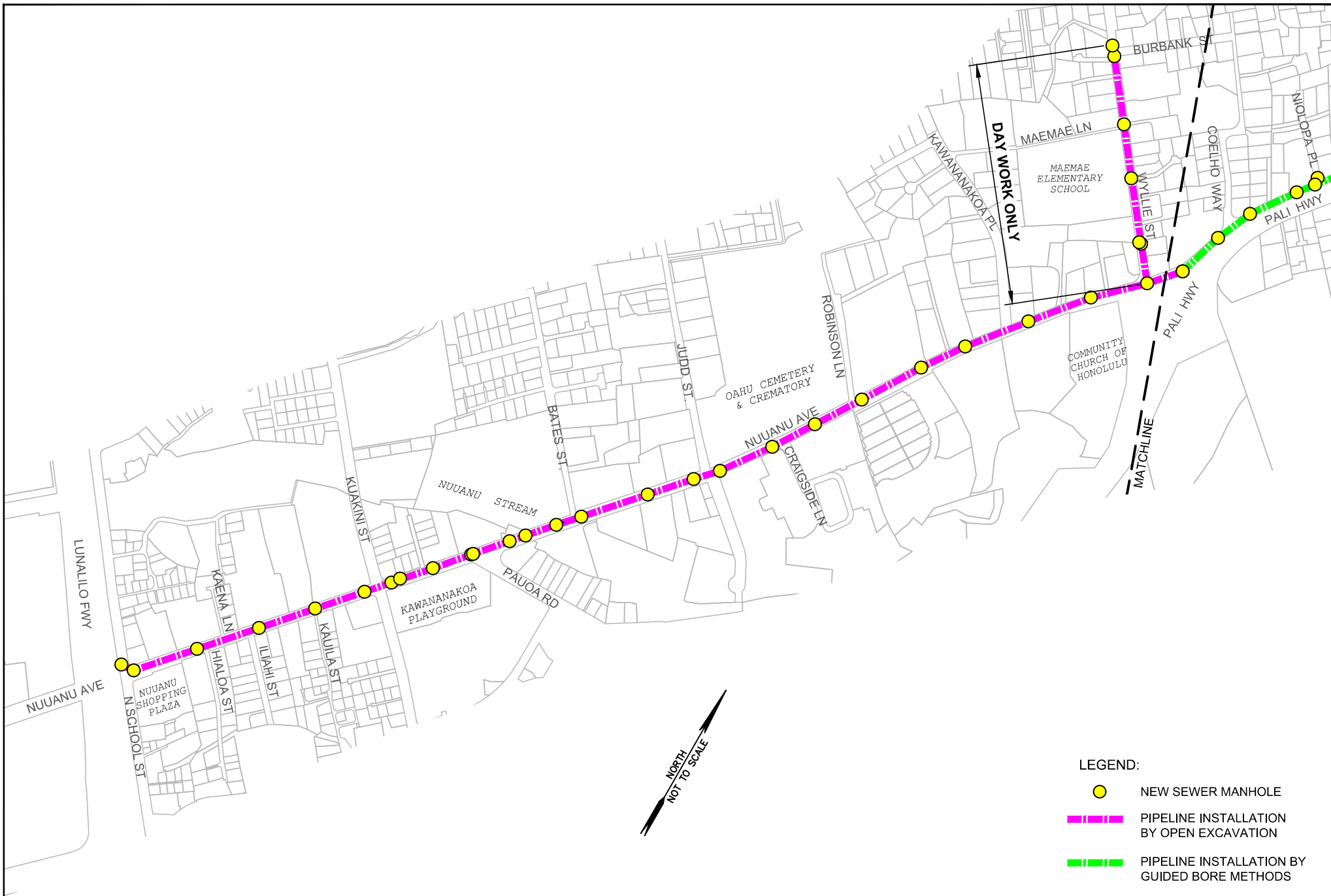

- LEGEND:**
- NEW SEWER MANHOLE
 - PIPELINE INSTALLATION BY OPEN EXCAVATION
 - PIPELINE INSTALLATION BY GUIDED BORE METHODS



CITY AND COUNTY OF HONOLULU
DEPARTMENT OF ENVIRONMENTAL SERVICES

DOWSETT HIGHLANDS RELIEF SEWER PROJECTS
NUUANU AVENUE (SCHOOL ST. TO WYLLIE ST.) AND
PALI HIGHWAY (WYLLIE ST. TO NUUANU PALI DR.) + DOWSETT AVE.
FIGURE 1 OF 2